

Page No.



Sparex Replacement
Massey Ferguson Parts

Industrial Seal Kits and Miscellaneous

- 1 — Industrial Seal Kits
- 2 — Zippo & Miscellaneous

These parts are Sparex parts and are not manufactured by the Original Equipment Manufacturer. Original Manufacturers names, part numbers and descriptions are quoted for reference purposes only and are not intended to indicate that our replacement parts are made by the Original Equipment Manufacturer.

MF13

Sparex Replacement
Massey Ferguson Parts

Industrial Loader Seal Kits

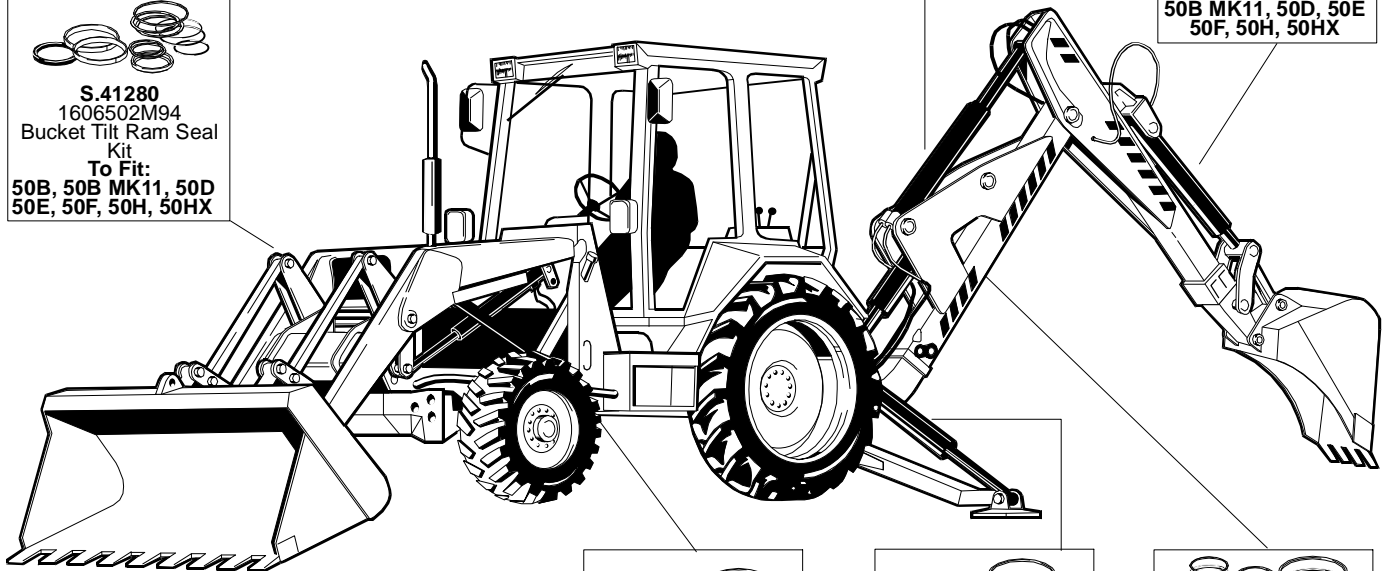

These parts are Sparex parts and are not manufactured by the Original Equipment Manufacturer. Original Manufacturers names, part numbers and descriptions are quoted for reference purposes only and are not intended to indicate that our replacement parts are made by the Original Equipment Manufacturer.



MF13

Sparex Replacement
Massey Ferguson Parts

Zippo and Miscellaneous

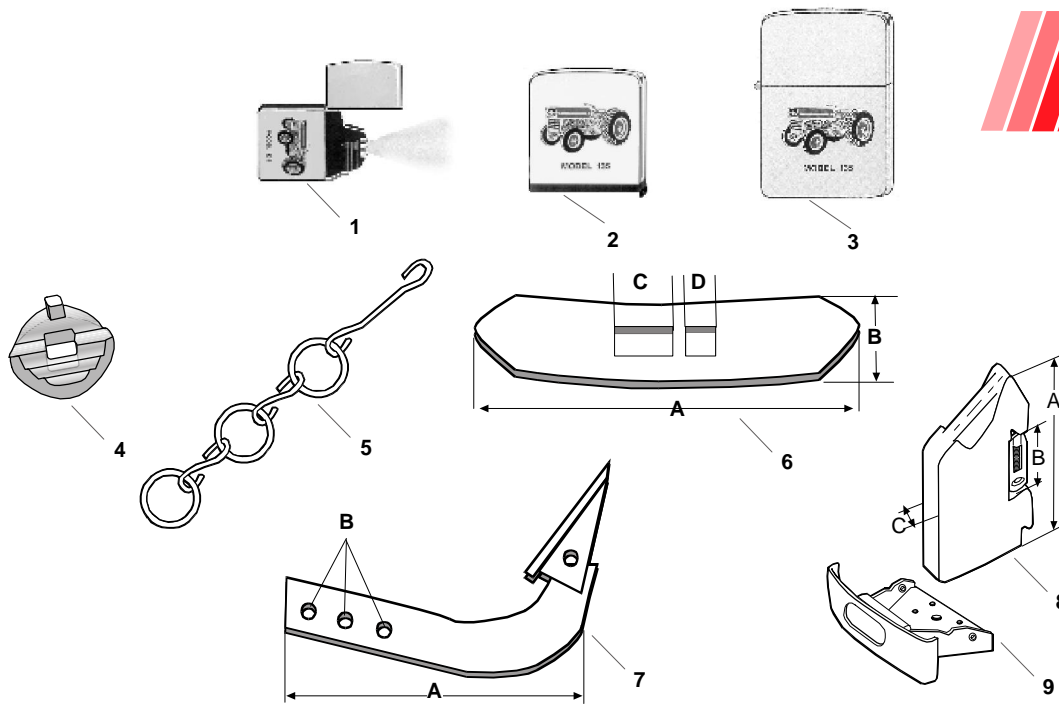

SPAREX No.	DESCRIPTION	EQUIVALENT	TRACTOR MODEL
1	S.61841 MF "Model 135" ZipLight		
2	S.61727 MF "Model 135" Zippo Tape Measure (6 1/2")		
3	S.61842 MF "Model 135" Zippo Lighter		
4	S.66509 Cultivator Washer	686187M1	
5	S.52661 Grain Drill Drag Chain		
6	S.52658 Cultivator Shovel (A=11 1/4", B=2", C=1 7/16"x9/16", D=9/16")		
7	S.52659 Scarifier Shank (A=15.66", B=.66")		
8	S.42608 Front Weight & Latch Assembly - 50 lb (A=14", B=6", C=2")	1681773M91	MF 240, 253, (375, 390, 390T, 398, SN B18009>), (399 w/ 1006.6 Engine), 3050, 3060, 3065, 3070, 3090
9	S.42745 Bumper/Weight Bracket	899628M92	MF35, 35UK, 135, 135UK, 20, 2135

These parts are Sparex parts and are not manufactured by the Original Equipment Manufacturer. Original Manufacturers names, part numbers and descriptions are quoted for reference purposes only and are not intended to indicate that our replacement parts are made by the Original Equipment Manufacturer.