

## Sparex Replacement Parts - Long

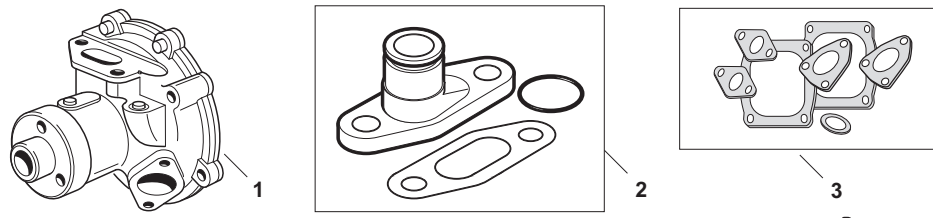

## Water Pump, Fan, Radiator and Related Components

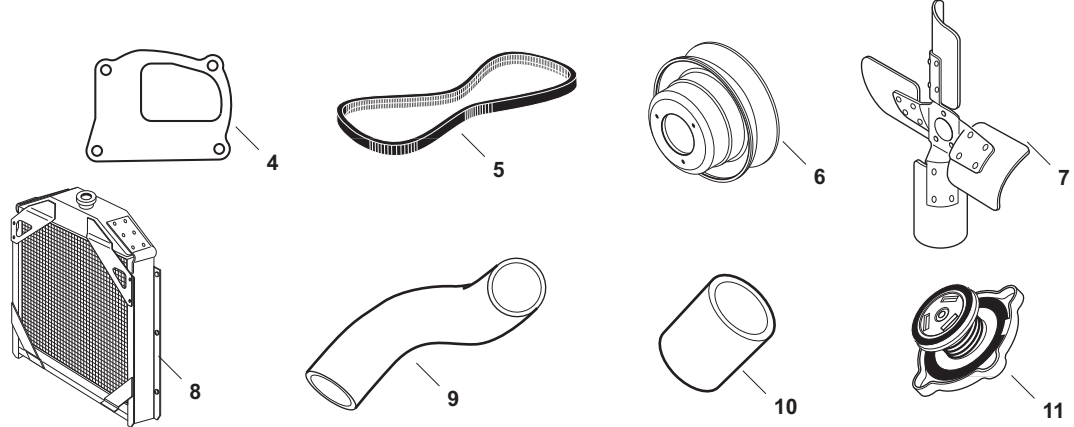

SPAREX No.	DESCRIPTION	EQUIVALENT	TRACTOR MODEL
1	<b>S.60245</b> Water Pump w/ Mounting Gasket	TX10252	260C, 310, 310C, 310DT, 320, 350, 360, 360C, 445, 445DT, 445SD, 460, 460DT, 460SD, 460V, 510, 510DT, 560, 560DT, 560DTE, 610, 610C, 610DT, 610DTE, 610C, 2310, 2510, 2510DTC, 2510SD, 2510SD-DTC, 2260, 2360, 2360DTC, 2460, 2460DTC, 2460SD, 2460SD-DTC, 2610, 2610DTC, 2610SD, 2610SD-DTC
2	<b>S.62260</b> Adaptor w/ Gasket	TX10273	260C, 310, 310C, 320, 350, 360, 360C, 445, 445DT, 445SD, 445V, 460, 460DT, 460SD, 460V, 510, 510DT
3	<b>S.58900</b> Water Pump Gasket Set - Use w/ Water Pump S.62045		260C, 310, 310C, 320, 350, 360, 360C, 445, 445DT, 445SD, 445V, 460, 460DT, 460SD, 460V, 510, 510DT, 560, 560DT, 560DTE, 610, 610DT, 610DTE, 610C, 2310, 2510, 2510DTC, 2510SD, 2510SD-DTC, 2260, 2360, 2360DTC, 2460, 2460DTC, 2460SD, 2460SD-DTC
4	<b>S.62984</b> Gasket - Water Pump	TX10279	260C, 310, 310C, 320, 350, 360, 360C, 445, 445DT, 445SD, 445V, 460, 460DT, 460SD, 460V, 510, 510DT, 560, 560DT, 560DTE, 610, 610DT, 610DTE, 610C, 2310, 2510, 2510DTC, 2510SD, 2510SD-DTC, 2260, 2610DTC, 2610SD, 2610SD-DTC, 2260, 2360, 2360DTC, 2460, 2460DTC, 2460SD, 2460SD-DTC
5	<b>S.18606</b> Fan Belt	TX10276	260C, 310, 310DT, 310C, 320, 350, 360, 360C, 445, 445DT, 445SD, 445V, 460, 460DT, 460SD, 460V, 510, 510DT, 560, 560DT, 560DTE, 610, 610DT, 610DTE, 610C, 2310, 2510, 2510DTC, 2510SD, 2510SD-DTC, 2260, 2360, 2460, 2460DTC, 2460SD, 2460SD-DTC
6	<b>S.69802</b> Pulley - Water Pump	TX10257	260C, 310, 310DT, 310C, 320, 350, 360, 360C, 445, 445DT, 445SD, 445V, 460, 460DT, 460SD, 460V, 510, 510DT, 560, 560DT, 560DTE, 610, 610DT, 610DTE, 610C, 2310, 2510, 2510DTC, 2510SD, 2510SD-DTC, 2260, 2360, 2460, 2460DTC, 2460SD, 2460SD-DTC
7	<b>S.69800</b> Fan - 4 Blade - Metal	TX10256	350, 360, 360C, 445, 445DT, 445SD, 460, 460DT, 460SD, 460V, 510, 510DT, 550, 550DT, 2510, 2510DTC, 2510SD, 2510SD-DTC, 2360, 2360DTC, 2460, 2460DTC, 2460SD, 2460SD-DTC
8	<b>S.62342</b> Radiator w/ Cap	TX10440 TX15073	260C, 310, 310C, 310DT, 320, 350, 360, 360C, 445, 445DT, 445SD, 460, 460DT, 460V, 510, 510DT, 550, 550DT, 560, 560DT, 560DTE, 610, 610C, 610DT, 610DTE, 2510, 2510DTE, 2510SD, 2510SD-DTC, 2610, 2610DTC, 2610SD, 2610SD-DTC
9	<b>S.63046</b> Radiator Hose - Top	TX10443	260C, 310, 310C, 310DT, 320, 350, 360, 360C, 445, 445DT, 445SD, 460, 460DT, 460SD, 460V, 510, 510DT, 2510, 2510DTC, 2510SD, 2510SD-DTC, 2360, 2360DTC, 2460, 2460DTC, 2640SD, 2460SD-DTC
10	<b>S.63043</b> Radiator Hose - Bottom	TX10444	260C, 310, 310C, 310DT, 320, 350, 360, 360C, 445, 445DT, 445SD, 460, 460DT, 460SD, 460V, 510, 510DT, 550, 550DT, 2310, 2510, 2510DTC, 2510SD, 2510SD-DTC, 2610, 2610DTC, 2610SD, 2610SD-DTC
11	<b>S.63104</b> Radiator Cap	TX10441	260C, 310, 310C, 310DT, 320, 350, 360, 360C, 445, 445DT, 445SD, 460, 460DT, 460V, 510, 510DT, 550, 550DT, 560, 560DT, 560DTE, 610, 610C, 610DT, 610DTE, 2510, 2510DTE, 2510SD, 2510SD-DTC, 2610, 2610DTC, 2610SD, 2610SD-DTC

Please see Index for alternative O.E. part numbers.

These parts are Sparex parts and are not manufactured by the Original Equipment Manufacturer. Original Equipment Manufacturer names, part numbers and descriptions are quoted for reference purposes only.

**Thermostats, Tubes,  
Block Heater and  
Related Components**

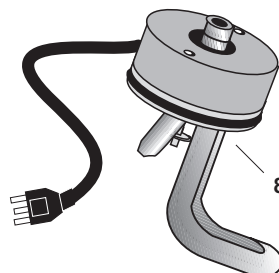
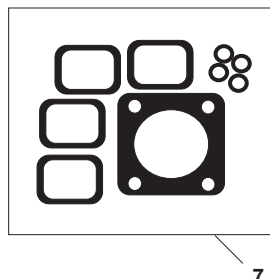
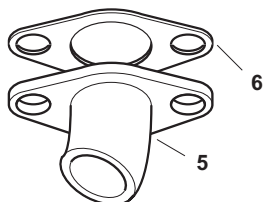
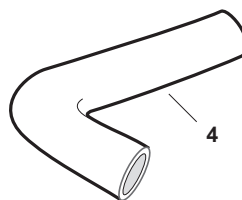
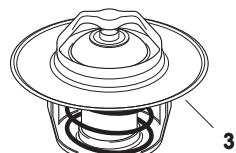
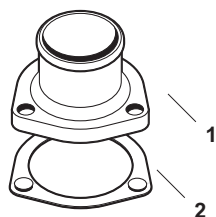

SPAREX No.	DESCRIPTION	EQUIVALENT	TRACTOR MODEL
1	<b>S.62262</b> Thermostat Cover	TX10280	260C, 310, 310C, 310DT, 350, 360, 360C, 445, 445DT, 445SD, 445V, 460, 460DT, 460SD, 460V, 510, 510DT, 2510, 2510DTC, 2510SD, 2510SD-DTC, 2360, 2360DT, 2460, 2460DTC, 2460SD, 2460SD-DTC
2	<b>S.59158</b> Gasket - Thermostat	TX10283	260C, 310, 310C, 310DT, 350, 360, 360C, 445, 445DT, 445SD, 460, 460DT, 460SD, 460V, 510, 510DT, 2510, 2510DTC, 2510SD, 2510SD-DTC, 2360, 2360DT, 2460, 2460DTC, 2460SD, 2460SD-DTC
3	<b>S.63078</b> Thermostat	TX10258 TX13205	260C, 310, 310C, 310DT, 320, 350, 360, 360C, 445, 445DT, 445SD, 445V, 460, 460DT, 460SD, 460V, 510, 550, 550DT, 560, 510DT, 560, 560DT, 560DTE, 610, 610C, 610DT, 610DTE, 2310, 2510, 2510DTC, 2510SD, 2510SD-DTC, 2610, 2610DTC, 2610SD, 2610SD-DTC, 2260, 2360, 2360DTC, 2460, 2460DTC, 2460SD, 2460SD-DTC
4	<b>S.41317</b> By-Pass Hose (Cut to length )	TX12329	560, 560DT, 560DTE, 610, 610C, 610DT, 610DTE, 2610, 2610DTC, 2610SD, 2610SD-DTC
5	<b>S.59004</b> Tube - Upper (Bottom Hose)	TX10261	260C, 310, 310C, 350, 360, 360C, 445, 445DT, 445SD, 445V, 460, 460DT, 460SD, 460V, 510, 510DT, 550, 550DT, 560, 560DT, 560DTE, 610, 610C, 610DT, 610DTE, 2310, 2510, 2510DTC, 2510SD, 2510SD-DTC, 2610, 2610DTC, 2610SD, 2610SD-DTC, 2260, 2360, 2360DTC, 2460, 2460DTC, 2460SD, 2460SD-DTC
6	<b>S.57051</b> Tube Gasket	TX10285	260C, 310, 310C, 350, 360, 360C, 445, 445DT, 445SD, 445V, 460, 460DT, 460SD, 460V, 510, 510DT, 560, 560DT, 560DTE, 610, 610C, 610DT, 610DTE, 2310, 2510, 2510DTC, 2510SD, 2510SD-DTC, 2610, 2610DTC, 2610SD, 2610SD-DTC, 2260, 2360, 2360DTC, 2460, 2460DTC, 2460SD, 2460SD-DTC
7	<b>S.67255</b> Gasket Set - Water Manifold	TX12331 x 4 TX50047 x 4 TX16846 x 1	550, 550DT, 2610, 2610DTC, 2610SD, 2610SD-DTC
8	<b>S.70746</b> Block Heater (36mm Core Plug)	764161	260C, 310, 310C, 310DT, 320, 320DT, 350, 360, 360C, 445, 445V, 445DT, 445SD, 460, 460V, 460DT, 460SD, 510, 510DT, 550, 550DT, 560, 560DT, 560DTE, 610, 610C, 610DT, 610DTE, 2310DT, 2510, 2510DTC, 2510SD, 2510SD-DTC, 2610, 2610DTC, 2610SD, 2610SD-DTC, 2360, 2360DTC, 2460, 2460SD, 2460SD-DTC

Please see Index for alternative O.E. part numbers.

These parts are Sparex parts and are not manufactured by the Original Equipment Manufacturer.

Original Equipment Manufacturer names, part numbers and descriptions are quoted for reference purposes only.