

**Page No.****1****Brake Shoes, Drums  
and Related Components**

Please see Index for alternative O.E. part numbers.

These parts are Sparex parts and are not manufactured by the Original Equipment Manufacturer.  
Original Equipment Manufacturers names, part numbers and descriptions are quoted for reference purposes only.

# F6

Spare Parts for FORD Tractors Built 1939 to 1964

## Brakes

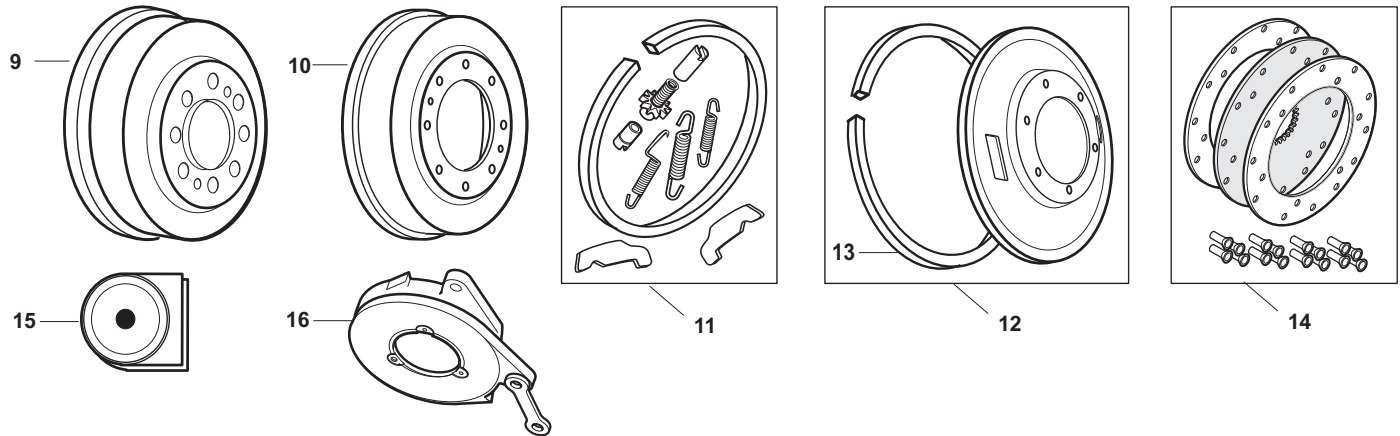
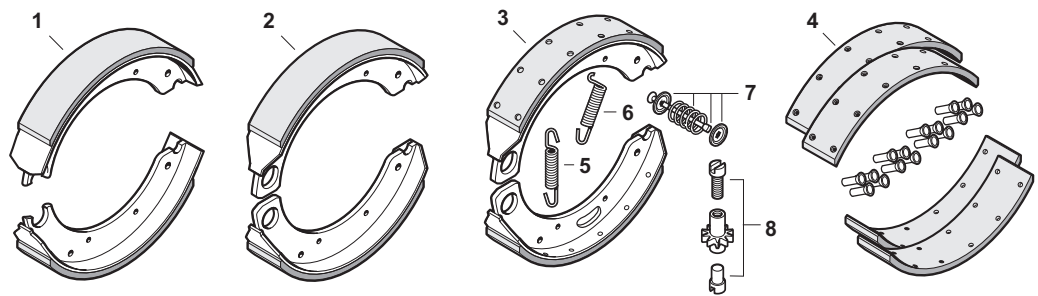

| SPAREX No. | DESCRIPTION  | EQUIVALENT                        | TRACTOR MODEL   |
|------------|--|-----------------------------------|---|
| 1          | <b>S.61873</b> Brake Shoes<br>(Priced each - Order in multiples of 2)  | 8N2200B                           | <b>8N, NAA, Jubilee</b>                                   |
| 2          | <b>S.61874</b> Brake Shoes<br>(Priced each - Order in multiples of 2)  | NCA2218B                          | <b>600, 700, 800, 900, 601, 701, 801, 901, 2000, 4000</b> |
| 3          | <b>M06-01-01</b> Brake Shoe (1 piece)  | 957E2019A                         | <b>Dexta, Super Dexta</b>                                 |
| 4          | <b>S.04163</b> Brake Lining Kit (4 Linings + Rivits)   | 957E2020B                         | <b>Dexta, Super Dexta</b>                                 |
| 5          | <b>S.42067</b> Spring - Primary  | 957E2035                          | <b>Dexta, Super Dexta</b>                                 |
| 6          | <b>S.01785</b> Spring - Anchor   | 957E2036                          | <b>Dexta, Super Dexta</b>                                 |
| 7          | <b>S.66174</b> Brake Shoe Pin Kit  | 957E2069A<br>957E2068<br>957E2066 | <b>Dexta, Super Dexta</b>                                 |
| 8          | <b>S.41564</b> Brake Adjuster Assembly   | 957E2039<br>957E2043<br>957E2044  | <b>Dexta, Super Dexta</b>                                 |
| 9          | <b>S.66516</b> Brake Drum (Cast Iron)  | 8N1126                            | <b>8N, NAA, Jubilee</b>                                   |
| 10         | <b>S.66518</b> Brake Drum (Cast Iron)  | NCA1126A                          | <b>600, 700, 800, 900, 601, 701, 801, 901, 2000, 4000</b> |
| 10         | <b>S.66170</b> Brake Drum  | 957E1126A                         | <b>Dexta, Super Dexta</b>                                 |
| 11         | <b>S.66604</b> Brake Hardware Kit<br>Contains: 2 Anchors, Complete Adjuster, Adjuster, Return, Secondary Springs, Dust Shield Seal |                                   | <b>8N, NAA, Jubilee</b>                                   |
| 12         | <b>S.66605</b> Brake Shield Assembly<br>(w/ Felt Seal) Restoration Quality   | 8N2255                            | <b>8N, NAA, Jubilee</b>                                   |
| 13         | <b>S.66621</b> Brake Shield Felt Seal  | 8N2217                            | <b>8N, NAA, Jubilee</b>                                   |
| 14         | <b>S.13975</b> Brake Lining Kit<br>(4 Linings + Rivits)  | E1ADDN2284                        | <b>Fordson Super Major</b>                                |
| 15         | <b>S.58902</b> Actuator Rod Seal   | E104FB9                           | <b>Fordson Super Major</b>                                |
| 16         | <b>S.66740</b> Brake Actuator Assembly-<br>Disc Brakes   | E92FB9<br>E90FB9                  | <b>Fordson Super Major</b>                                |



Please see Index for alternative O.E. part numbers.

These parts are Sparex parts and are not manufactured by the Original Equipment Manufacturer. Original Equipment Manufacturer names, part numbers and descriptions are quoted for reference purposes only.