

## Electrical, Instruments and Related Components

Page No.

- 1 — Starting System  
and Related Components
- 2 — Charging System  
and Related Components
- 3 — Batteries, Cables  
and Related Components
- 4-5 — Ignition, Tune-Up Kits  
and Related Components
- 6 — Gauges, Instruments  
and Related Components
- 7 — Headlights, Lighting and Related Components
- 8 — Worklights and Related Components

# F10

## Sparex Replacement Spare Parts - Ferguson

### Starting System and Related Components

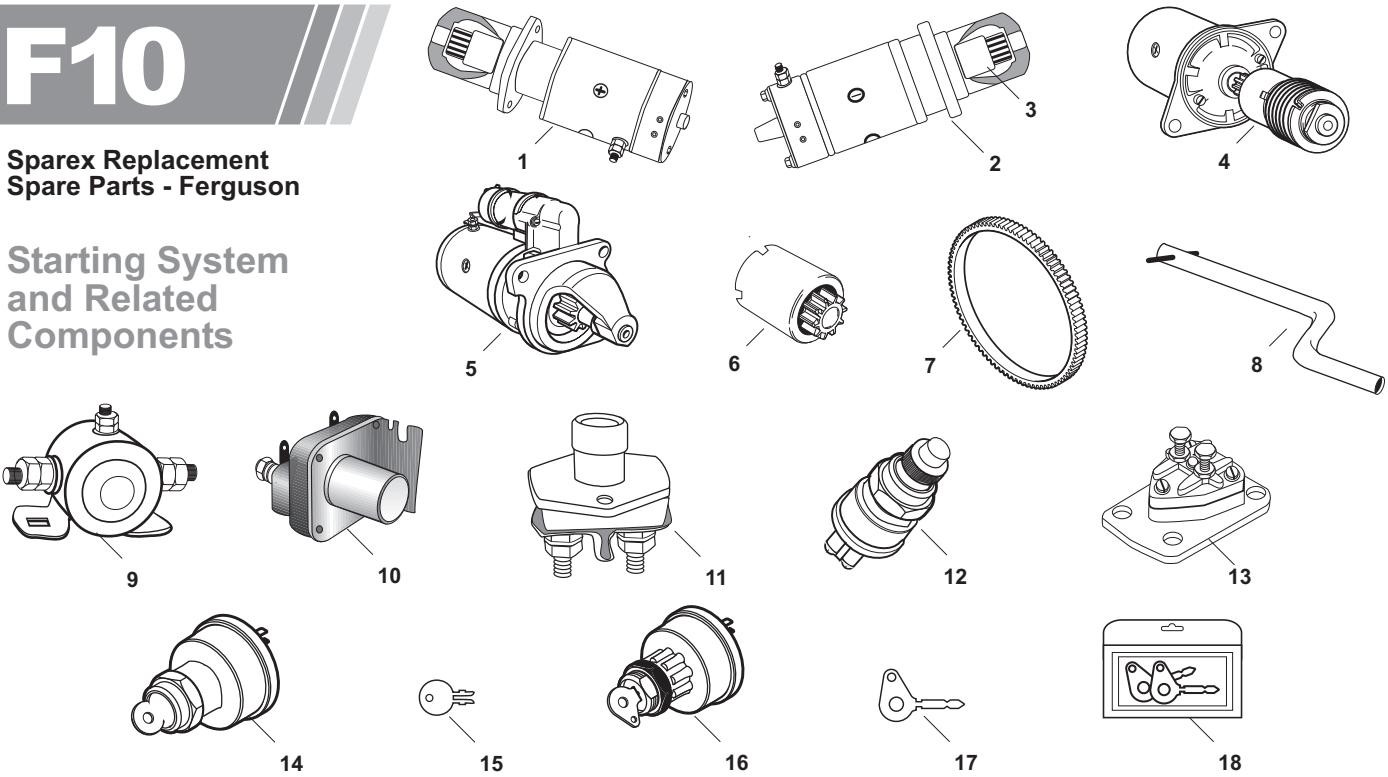

SPAREX No.	DESCRIPTION	EQUIVALENT	TRACTOR MODEL
1	<b>S.43248</b> Starter (6 Volt) New - Not Rebuilt	181541M91	<b>(TO20, TO30, TO35 &gt;SN 161250)</b>
2	<b>S.60354</b> Starter (6 Volt) 2 Bolt Mount, Type V139	829853M91 25519	<b>(TEA20, 80, 85mm Gas &gt;SN 200001)</b>
3	<b>S.43366</b> Starter Drive		Fits S.60354 Starter
4	<b>S.41136</b> Starter (12 Volt)	829803M91 25038	<b>(TEA20 85mm Gas, SN200001&gt;)</b>
5	<b>S.60360</b> Starter (12 Volt) Economy - Temperate Climate		<b>(TEF20 20C Diesel), (FE35, TO35 23 Diesel)</b>
5	<b>S.60353</b> Starter (12 Volt) Heavy Duty (2.7 Kw)		<b>(TEF20 20C Diesel), (FE35, TO35 23 Diesel)</b>
5	<b>S.60991</b> Starter (12 Volt) Heavy Duty (3.0 Kw)		<b>(TEF20 20C Diesel), (FE35, TO35 23 Diesel)</b>
6	<b>S.43365</b> Starter Drive (9 Teeth) Stamped: V139m M418, 25519		<b>(TE20, TEA20 w/ Lucas Starter)</b>
7	<b>S.42727</b> Ring Gear (145 Teeth)	1750034M1	<b>(TE20, TO20, TO30, TO35, F40 Continental Gas)</b>
7	<b>S.42422</b> Ring Gear (12 Volt)	825452M1	<b>(TEA20 85mm Gas), (FE35 87mm Gas)</b>
8	<b>S.13008</b> Crank - Starter	180890M1	<b>TE20, TO20, TO30</b>
9	<b>S.60822</b> Solenoid (6 Volt)	182330M91	<b>TO35</b>
10	<b>S.66323</b> Solenoid (6 Volt)		<b>(TEF20 20C Diesel)</b>
11	<b>S.60821</b> Starter Switch - Push Button	181679M1	<b>TO20, TO30</b>
12	<b>S.60824</b> Starter Switch - Push Button	189158M91	<b>TO35, F40</b>
13	<b>S.42538</b> Starter Switch - Gear Stick Operated	829960M91 76418	<b>(TEA20 80, 85mm Gas)</b>
14	<b>S.60820</b> Ignition/Light Switch w/ Key (4 Position)	180681M93	<b>TE20, TEA20, TO20, TO30, (TO35 Gas), F40</b>
15	<b>S.60835</b> Key	180292M1	<b>TE20, TEA20, TO20, TO30, (TO35 Gas), F40</b>
16	<b>S.41288</b> Starter Switch - Cold Start	883920M1	<b>(FE35 23C Diesel)</b>
17	<b>S.03990</b> Key - Starter Switch		<b>(FE35 23C Diesel)</b>
18	<b>S.04024</b> Key - Starter Switch (Pack of 2)		<b>(FE35 23C Diesel)</b>

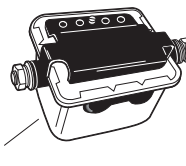
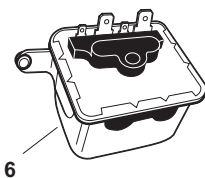
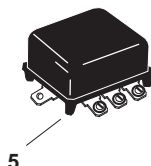
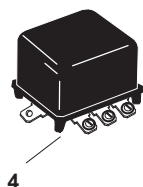
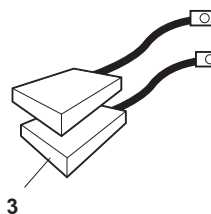
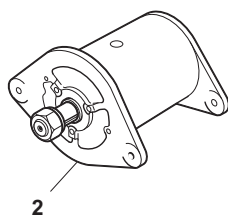
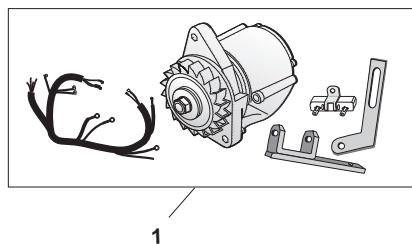

	SPAREX No.	DESCRIPTION	EQUIVALENT	TRACTOR MODEL
1	<b>S.43233</b>	Alternator Conversion Kit		( <b>TO30</b> less Tractormeter)
2	<b>S.41157</b>	Generator w/ Fan - Lucas Type	22703 22791	( <b>TEA20, TEF20, FE35, TO35</b> 85, 87mm, Gas, 20C, 23C Diesel)
3	<b>S.41160</b>	Brush Set - Generator - Lucas Type	227541	( <b>TEA20, TEF20, FE35, TO35</b> 85, 87mm, Gas, 20C, 23C Diesel)
4	<b>S.43246</b>	Voltage Regulator - 6 Volt	180142M92	<b>TO20, TO30, (TO35 Gas, &gt;SN 161250)</b>
5	<b>S.43247</b>	Voltage Regulator - 12 Volt	182548M92	( <b>TO35 Gas, SN 161251&gt;</b> ), ( <b>TO35 23C Diesel</b> ), <b>F40</b>
6	<b>S.41166</b>	Voltage Regulator - 12 Volt	NCB120	( <b>TEA20 85mm Gas</b> ), ( <b>TEF20 20C Diesel, &gt;SN 381659</b> )
7	<b>S.41167</b>	Voltage Regulator - 12 Volt	37228F	( <b>FE35 87mm Gas, &gt;SN 304622, 23C Diesel</b> )

# F10

## Sparex Replacement Spare Parts - Ferguson

### Battery Cables and Related Components

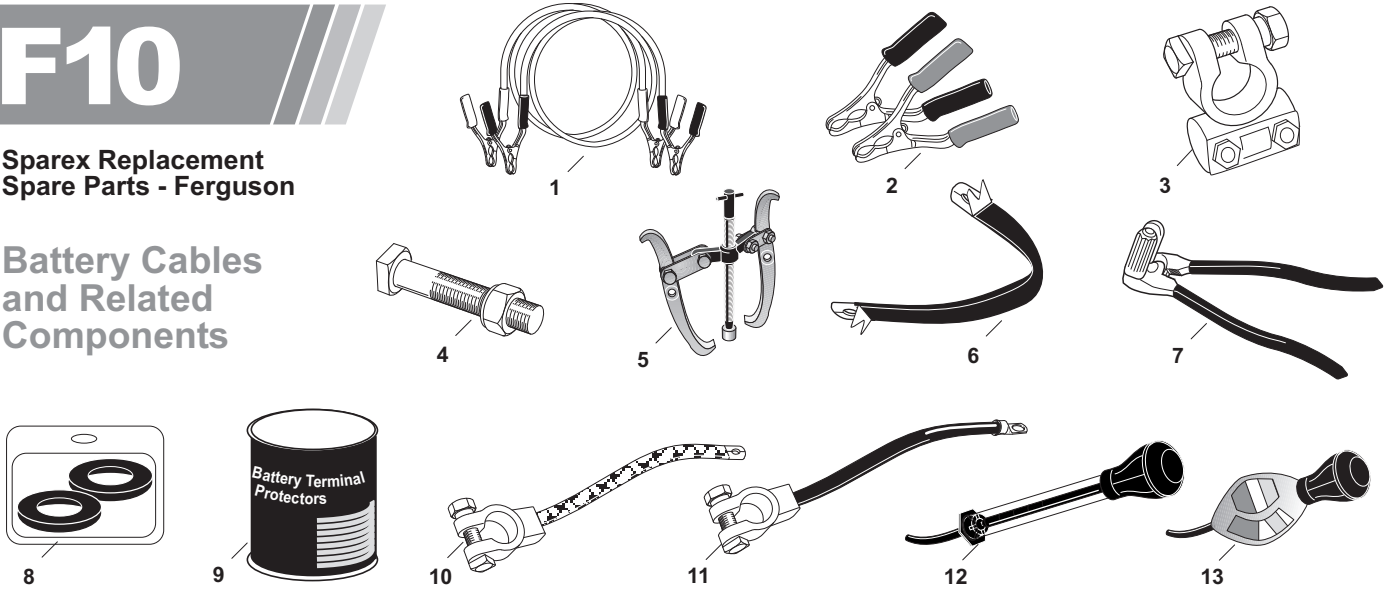

SPAREX No.	DESCRIPTION	EQUIVALENT	TRACTOR MODEL
1	<b>S.20556</b> Jumper Cable - Extra Heavy Duty - 2 Gauge Cooper Wire (20')		
2	<b>S.20557</b> Jumper Cable Clamp - Extra Heavy Duty Red/Black, Zinc Plated Steel (Set of 2)		
3	<b>S.20561</b> Battery Terminal - Heavy Duty - (Card of 10)		Fits: 6 to 2/0 gauge cables
4	<b>S.20570</b> Battery Terminal Bolt & Nut (5/16"-18 x 1 1/4")		
5	<b>S.20563</b> Battery Terminal Puller		
6	<b>S.20564</b> Battery Carry Strap for Post Terminal Batteries (14")		
7	<b>S.20565</b> Battery Terminal Spreader		
8	<b>S.20562</b> Terminal Protectors - Red/Black (Qty 2)		
9	<b>S.20594</b> Terminal Protectors - Black (Qty 100)		
10	<b>S.20545</b> Braided Ground Straps Flat - 2 Gauge (7")		Fits up to 3/8" Stud
10	<b>S.20546</b> Braided Ground Straps Flat - 2 Gauge (9")		Fits up to 3/8" Stud
10	<b>S.20547</b> Braided Ground Straps Flat - 2 Gauge (11")		Fits up to 3/8" Stud
10	<b>S.20548</b> Braided Ground Straps Flat - 2 Gauge (14")		Fits up to 3/8" Stud
10	<b>S.20549</b> Braided Ground Straps Flat - 2 Gauge (16")		Fits up to 3/8" Stud
10	<b>S.20550</b> Braided Ground Straps Flat - 2 Gauge (19")		Fits up to 3/8" Stud
10	<b>S.20551</b> Braided Ground Straps Flat - 2 Gauge (24")		Fits up to 3/8" Stud
11	<b>S.20552</b> Battery Cable Top Post - Black - 2 Gauge (10")		Fits up to 3/8" Stud
11	<b>S.20553</b> Battery Cable Top Post - Black - 2 Gauge (15")		Fits up to 3/8" Stud
11	<b>S.20554</b> Battery Cable Top Post - Black - 2 Gauge (20")		Fits up to 3/8" Stud
11	<b>S.20555</b> Battery Cable Top Post - Black - 2 Gauge (23")		Fits up to 3/8" Stud
11	<b>S.20567</b> Battery Cable Top Post - Black - 2 Gauge (27")		Fits up to 3/8" Stud
11	<b>S.20568</b> Battery Cable Top Post - Black - 2 Gauge (32")		Fits up to 3/8" Stud
11	<b>S.20569</b> Battery Cable Top Post - Black - 2 Gauge (34")		Fits up to 3/8" Stud
12	<b>S.20559</b> Temperature Correcting Battery Hydrometer - Temperature & Float Calibrated Reading		
13	<b>S.20558</b> Battery Tester - Dial indicates battery charge & specific gravity		

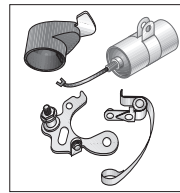
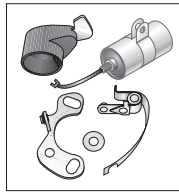
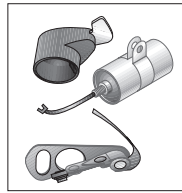
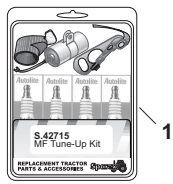

# F10

**Sparex Replacement  
Spare Parts - Ferguson**

**Ignition, Tune-up  
and Related  
Components**

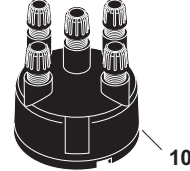
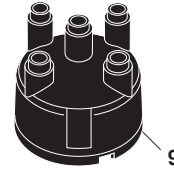
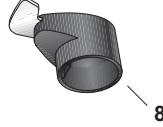
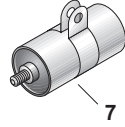
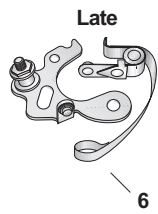
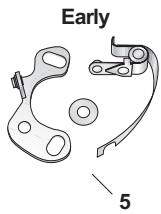

SPAREX No.	DESCRIPTION	EQUIVALENT	TRACTOR MODEL
1	<b>S.42715</b> Tune-up Kit w/ Clip Held Cap (Points, Condenser, Rotor, 4 Autolite 386 Plugs)		(TO20, TO30, TO35, F40 Z120, 129, 134 - Delco Distributor)
1	<b>S.42716</b> Tune-up Kit w/ Screw Held Cap (Points, Condenser, Rotor, 4 Autolite 386 Plugs)		(TO35 Service Replacement Engine - Delco Distributor)
1	<b>S.42733</b> Tune-up Kit - Standard Motors (Points, Condenser, Rotor, 4 Autolite 425 Plugs)		(TEA20, FE35 80, 85, 87mm Gas w/ Early Distributor) (See #5 or 6 to identify Early or Late)
1	<b>S.42734</b> Tune-up Kit - Standard Motors (Points, Condenser, Rotor, 4 Autolite 425 Plugs)		(TEA20, FE35 80, 85, 87mm Gas w/ Late Lucas Distributor) (See #5 or 6 to identify Early or Late)
2	<b>S.61558</b> Ignition Kit w/ Clip Held Cap (Points, Condenser, Rotor)	839011M91 1750498M1	(TO20, TO30, TO35, F40 Delco Distributor - Z120, 129, 134)
2	<b>S.61909</b> Ignition Kit w/ Screw Held Cap (Points, Condenser, Rotor)		(TO35 Delco Distributor - Service Replacement Eng)
3	<b>S.42772</b> Ignition Kit (Points, Condenser, Rotor)		(TE20 Z120), (TEA20, FE35 80, 85, 87mm Early Lucas Dist)
4	<b>S.42773</b> Ignition Kit (Points, Condenser, Rotor)		(TE20 Z120), (TEA20, FE35 80, 85, 87mm Late Lucas Distributor)
5	<b>S.42372</b> Point Set	407050	(TE20 Z120), (TEA20, FE35 80, 85, 87mm Early Lucas Distributor)
6	<b>S.42376</b> Point Set	423153	(TE20 Z120), (TEA20, FE35 80, 85, 87mm Late Lucas Distributor)
7	<b>S.42373</b> Condenser	407044	(TE20 Z120), (TEA20, FE35 80, 85, 87mm Lucas Distributor)
8	<b>S.42374</b> Rotor	408355	(TE20 Z120), (TEA20, FE35 80, 85, 87mm Lucas Distributor)
9	<b>S.61907</b> Distributor Cap - Clip Held - Delco		(TO20, TO30, TO35, F40 Z120, 129, 134)
9	<b>S.61908</b> Distributor Cap - Screw Held - Delco		(TO35 Service Replacement Engine)
10	<b>S.41169</b> Distributor Cap - Threaded Terminals - Lucas		(TE20 Z120), (TEA20, FE35 80, 85, 87mm)

These parts are Sparex parts and are not manufactured by the Original Equipment Manufacturer. Original Manufacturers names, part numbers and descriptions are quoted for reference purposes only and are not intended to indicate that our replacement parts are made by the Original Equipment Manufacturer.

# F10

## Sparex Replacement Spare Parts - Ferguson

### Ignition, Tune-up and Related Components

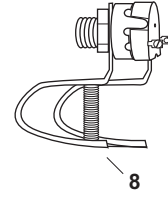
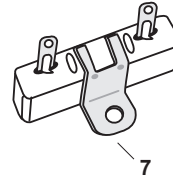
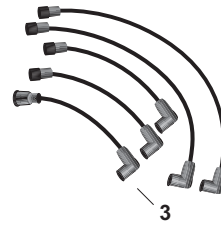
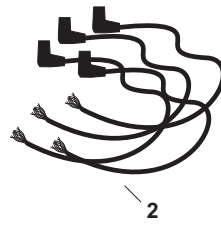
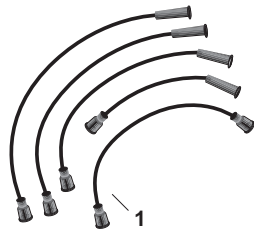

SPAREX No.	DESCRIPTION	EQUIVALENT	TRACTOR MODEL
1	<b>S.42779</b> Spark Plug Wire Set - Custom	830681M91	(TO20, TO30, TO35, F40 Z120, 129, 134, Delco Distributor)
2	<b>S.66441</b> Spark Plug Wire Set - 4 Cyl - 90° Boot High Quality Packard 440 Cable		Universal
2	<b>S.66442</b> Spark Plug Wire Set - 4 Cyl - 90° Boot Standard Copper Cable		Universal
2	<b>S.02097</b> Spark Plug Wire Set - 4 Cyl - Straight Boot High Quality Packard 440 Cable		Universal
3	<b>S.42375</b> Spark Plug Wire Set - 4 Cyl - Threaded Terminals		(TE20, TEA20, FE35 80, 85, 87mm - Lucas Distributor)
4	<b>S.42377</b> Ignition Coil - 12 Volt w/ Threaded Top Terminal	1015128M91 1038817M91	(TEA20, FE35 Standard Motors 85mm)
5	<b>S.61548</b> Coil - 6 Volt - Use w/ External Resistor	1024481M91	TO20, TO30, TO35
5	<b>S.61016</b> Coil - 12 Volt - Use w/ External Resistor		Universal
5	<b>S.67080</b> Coil - 12 Volt - Use w/ Internal Resistor		Universal
6	<b>S.61969</b> Spark Plug - Autolite 386 - 18mm (1/2" Reach)		(TE20, TO20, TO30, TO35, F40 Z120, 129, 134)
6	<b>S.61934</b> Spark Plug - Autolite 425 - 14mm (1/2" Reach)		(TEA20, FE35 80, 85, 87mm)
7	<b>S.43243</b> Ballist Resistor (.50 -.60 ohms)		Universal
8	<b>S.52671</b> Voltage Reducer - 12 Volt to 6 Volt		Universal

# F10

## Sparex Replacement Spare Parts - Ferguson

### Gauges, Instruments and Related Components



SPAREX No.	DESCRIPTION	EQUIVALENT	TRACTOR MODEL
1	S.42754 Tractormeter	193966M91 193967M91	(TO35 Z134), F40
2	S.41069 Tractormeter	1850093M93	(TO35 23C), (FE35 87mm Gas), (FE35 23C Diesel >SN 307657)
3	S.41091 Cable - Tractormeter	829487M91	(TO35 23C), (FE35 87mm Gas), (FE35 23C Diesel >SN 307657)
4	S.42905 Drive Assembly - Tractormeter		(TO20, TO30, TO35, F40 Z120, 129, 134)
5	S.42784 Oil Pressure Gauge - Chrome (3/8-24 UNF Female Thread)	180100M92	(TE20, TO20, TO30, TO35, F40 Z120, 129, 134)
6	S.61466 Oil Pressure Gauge (1/8" NPT) - Chrome w/ Male Fitting		TE20, TEA20, TO20, TO30
7	S.04342 Oil Pressure Gauge - Chrome	506902M92 1853097M91 3381907M1	TEF20, TO35, FE35
8	S.61171 Oil Pressure Gauge (40 PSI) Red/Green	506902M92	
9	S.61063 Oil Gauge - 50Lb (2" Dia) - Black		
10	S.60758 Oil Gauge - 80Lb (2" Dia) - Black		
11	S.42392 Grommet - Ammeter		Mounts S.04340 Ammeter to 2" Hole
12	S.04340 Ammeter (1 5/8" Dia) - Black Rubber Mounting Grommet S.42392 must be used to fit 2" Mounting Hole	36047F	TEF20, FE35
13	S.60759 Ammeter - 30 Amp (2" Dia) - Chrome		
14	S.61064 Ammeter - 50 Amp (2" Dia) - Chrome		
15	S.04341 Water Temperature Gauge - Chrome (74" Cable)	180727M91 881396M91	(FE35 87mm), F40
15	S.43045 Water Temperature Gauge - Chrome (46" Cable) Does not say "England"	180727M93	(TO35 w/ Continental Engine)
16	S.52672 Analog Hourmeter ( 2" ) - Black 12-24 Volt - Black Ring		Universal
17	S.52673 LCD Hourmeter (2") - Black 12-24 Volt - Black Ring		Universal

These parts are Sparex parts and are not manufactured by the Original Equipment Manufacturer. Original Manufacturers names, part numbers and descriptions are quoted for reference purposes only and are not intended to indicate that our replacement parts are made by the Original Equipment Manufacturer.

# F10

## Sparex Replacement Spare Parts - Ferguson

### Headlights, Lighting and Related Components

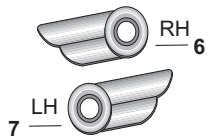

2

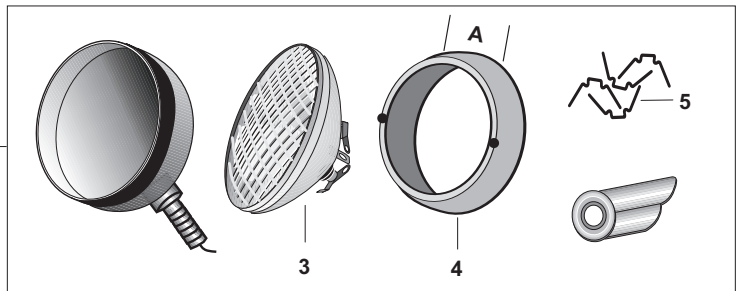

This kit and components are exactly like the original.

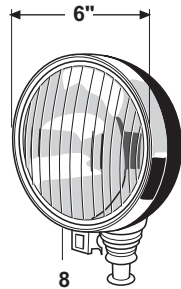

8

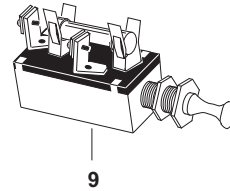

9

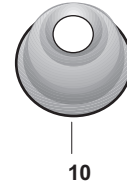

10

SPAREX No.	DESCRIPTION	EQUIVALENT	TRACTOR MODEL
1	<b>S.61633</b> Headlight (6") Steel Body w/ Rubber Bezel, Non-sealed Beam - Gray - 6 Volt		<b>Universal</b>
1	<b>S.61635</b> Headlight (6") Steel Body w/ Rubber Bezel, Non-sealed Beam - Black Primer - 6 Volt		<b>Universal</b>
1	<b>S.61634</b> Headlight (6") Steel Body w/ Rubber Bezel, Non-sealed Beam - Gray - 12 Volt		<b>Universal</b>
1	<b>S.61636</b> Headlight (6") Steel Body w/ Rubber Bezel, Non-sealed Beam - Black Primer - 12 Volt		<b>Universal</b>
2	<b>S.43370</b> Headlight Kit - LH (6") Primer - 6 Volt	231495M91	<i>Available April, 2006 (Assembly Required)</i>
2	<b>S.43371</b> Headlight Kit - LH (6") Primer - 12 Volt	186141M91 186142M91	<i>Available April, 2006 (Assembly Required)</i>
2	<b>S.43372</b> Headlight Kit - LH (6") Chrome Ring - 6 Volt -	231495M91	<i>Available April, 2006 (Assembly Required)</i>
2	<b>S.43374</b> Headlight Kit - LH (6") Chrome Ring - 12 Volt -	186141M91 186142M91	<i>Available April, 2006 (Assembly Required)</i>
2	<b>S.22342</b> Headlight Kit - RH (6") Primer - 6 Volt	231495M91	<i>Available April, 2006 (Assembly Required)</i>
2	<b>S.22343</b> Headlight Kit - RH (6") Primer - 12 Volt	186141M91 186142M91	<i>Available April, 2006 (Assembly Required)</i>
2	<b>S.22340</b> Headlight Kit - RH (6") Chrome Ring - 6 Volt -	231495M91	<i>Available April, 2006 (Assembly Required)</i>
2	<b>S.22341</b> Headlight Kit - RH (6") Chrome Ring - 12 Volt -	186141M91 186142M91	<i>Available April, 2006 (Assembly Required)</i>
3	<b>S.66415</b> Sealed Beam Bulbs (5 3/4") 6 Volt (4019 Bulb)	1002802M91	<b>(TE20, TEA20, TO20, TO30, TO35 &gt;SN 161250)</b>
3	<b>S.66416</b> Sealed Beam Bulbs (5 3/4") 12 Volt (4419 Bulb)	1752866M91	<b>(TO35 SN 161251&gt;), F40</b>
4	<b>S.43074</b> Headlight/Worklight Ring w/ Ground Wire (A=1 1/16" Thick) Use 5 3/4" Bulb - Chrome	1752311M91	<b>TE20, TEA20, TO20, TO30, TO35, F40</b>
4	<b>S.43057</b> Headlight/Worklight Ring w/ Ground Wire (A=1 1/16" Thick) Use 5 3/4" Bulb - Grey Primer	1752311M91	<b>TE20, TEA20, TO20, TO30, TO35, F40</b>
5	<b>S.43070</b> Clips - Bulb Retaining - Pack of 4	1750642M1	<b>TE20, TEA20, TO20, TO30, TO35, F40</b>
6	<b>S.66561</b> Winged Headlight Bracket - RH	510438M1	<b>TE20, TEA20, TO20, TO30, TO35, F40</b>
7	<b>S.66562</b> Winged Headlight Bracket - LH	510439M1	<b>TE20, TEA20, TO20, TO30, TO35, F40</b>
8	<b>S.61925</b> Headlamp - European Style - 12 Volt - Red w/ Bulb - Hi-Low Beam w/ Parking Light		<b>FE35</b>
9	<b>S.60828</b> Switch - Headlight (Fused)		<b>Universal</b>
10	<b>S.66599</b> Steel Headlight Socket - Primer - Restoration Quality		<b>TE20, TEA20, TO20, TO30, TO35, F40</b>

# F10

Sparex Replacement  
Spare Parts - Ferguson

Worklights  
and Related  
Components

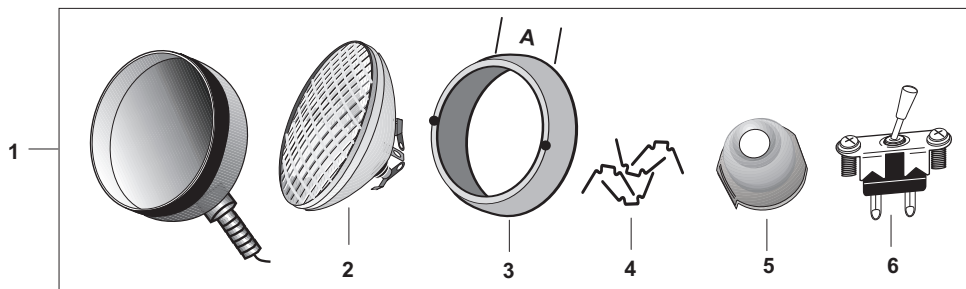

This kit and components are exactly like the original.

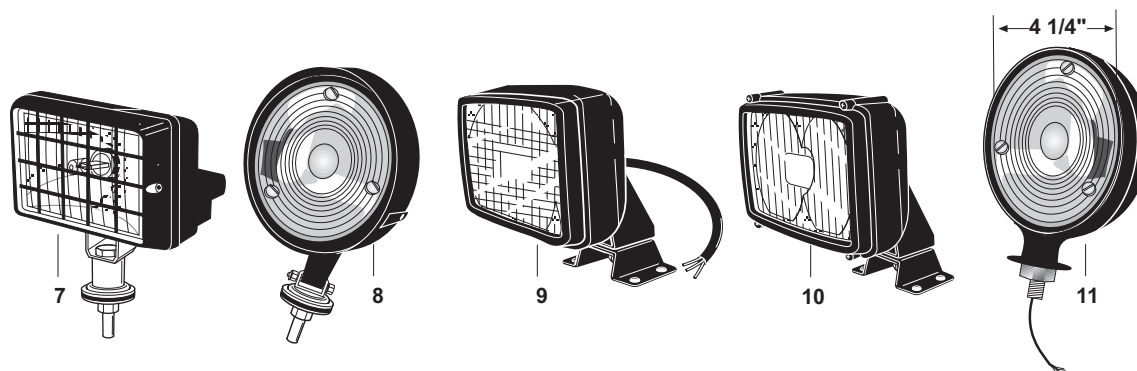

SPAREX No.	DESCRIPTION	EQUIVALENT	TRACTOR MODEL
1	<b>S.43375</b> Worklight Kit (6") Primer - 6 Volt - Assembly Required	1750692M91	Available April, 2006
1	<b>S.43376</b> Worklight Kit (6") Primer - 12 Volt - Assembly Required	182926M91	Available April, 2006
1	<b>S.43377</b> Worklight Kit (6") Chrome Ring - 6 Volt - Assembly Required	1750692M91	Available April, 2006
1	<b>S.43378</b> Worklight Kit (6") Chrome Ring - 12 Volt - Assembly Required	182926M91	Available April, 2006
2	<b>S.66415</b> Sealed Beam Bulbs (5 3/4") 6 Volt (4019 Bulb)	1002802M91	(TE20, TEA20, TO20, TO30, TO35 >SN 161250)
2	<b>S.66416</b> Sealed Beam Bulbs (5 3/4") 12 Volt (4419 Bulb)	1752866M91	(TO35 SN 161251>), F40
3	<b>S.43074</b> Headlight/Worklight Ring w/ Ground Wire (A=1 1/16" Thick) Use 5 3/4" Bulb - Chrome	1752311M91	TE20, TEA20, TO20, TO30, TO35, F40
3	<b>S.43057</b> Headlight/Worklight Ring w/ Ground Wire (A=1 1/16" Thick) Use 5 3/4" Bulb - Grey Primer	1752311M91	TE20, TEA20, TO20, TO30, TO35, F40
4	<b>S.43070</b> Clips - Bulb Retaining (Pack of 4)	1750642M1	TE20, TEA20, TO20, TO30, TO35, F40
5	<b>S.67089</b> Socket - Worklight Mount - Steel - Restoration Quality	1750677M1	TO20, TO30, TO35, F40
6	<b>S.66850</b> Switch - Worklight	1750656M1	TE20, TEA20, TO20, TO30, TO35, F40
7	<b>S.08509</b> Rectangular Work Lamp w/ On/Off Switch - Plastic 12 Volt - Halogen H3 Bulb - Universal Mount (6 3/4" x 4")		TE20, TEA20, TO20, TO30, TO35, F40
8	<b>S.02113</b> Round Work Lamp - On/Off Switch - Metal 12 Volt - Halogen Bulb -Universal Mount (4 1/2")		Universal
9	<b>S.51750</b> Rectangular Work Lamp - 4 Bolt Mount (1x 55w Halogen Bulb) Rotates (4 1/4" x 3 3/4")		Universal
10	<b>S.51753</b> Twin Beam Work Lamp w/ 4 Bolt Mount - (2x 55w Halogen Bulb) Rotates (6 1/8" x 3 3/4")		Universal
11	<b>S.61357</b> Universal Amber Light - 12 Volt - Both lenses Amber Does NOT include Flasher (3/8" Dia x 5/8" Long)		Universal